

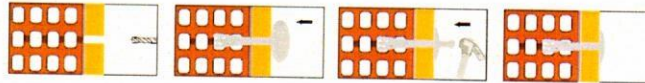

SPECO WIDE CAPPED WALL PLUG-DOWEL FOR THERMAL INSULATION

- ▶ It is an insulation panel connector.
- ▶ Used to fix the pressure resistant insulation materials for exterior masonry
- ▶ Can be used in all wall forms.
- ▶ Its tearing design makes the application easy
- ▶ It has high holding resistance
- ▶ Provides high resistance to adze impact
- ▶ The product design was developed by STAR PLASTIK A.Ş.



| PRODUCT TYPE | DIMENSIONS | | FIXATION | | | LOAD CAPACITY | | |
|-----------------------------------|------------------------------|-----------------------|-------------------------|------------------------|-------------------|---------------------|-----------|---------------|
| | Wall Plug Body Diameter (mm) | Wall Plug Length (mm) | On Hollow Surfaces (mm) | On Solid Surfaces (mm) | Hole Depth (min.) | Adherence Test (kN) | Pull (kN) | Scission (kN) |
| SPECO WIDE CAPPED WALL PLUG-BLACK | | | | | | | | |
| SP-GECO-01-06-01 | 60 | 100 | 11 | 10 | 11 | 0,56 | 0,7 | 1,78 |
| SP-GECO-01-08-01 | 80 | 100 | 11 | 10 | 11 | 0,56 | 0,7 | 1,78 |
| SP-GECO-01-10-01 | 100 | 100 | 11 | 10 | 11 | 0,56 | 0,7 | 1,78 |
| SP-GECO-01-12-01 | 120 | 100 | 11 | 10 | 11 | 0,56 | 0,7 | 1,78 |
| SP-GECO-01-14-01 | 140 | 100 | 11 | 10 | 11 | 0,56 | 0,7 | 1,78 |
| SP-GECO-01-16-01 | 160 | 100 | 11 | 10 | 11 | 0,56 | 0,7 | 1,78 |
| SP-GECO-01-18-01 | 180 | 100 | 11 | 10 | 11 | 0,56 | 0,7 | 1,78 |
| SP-GECO-01-20-01 | 200 | 100 | 11 | 10 | 11 | 0,56 | 0,7 | 1,78 |

Drill Diameter
On Hollow Surfaces
10 mm
On Solid Surfaces
11 mm

STAR PLASTIK YAPI ELEMANLARI
İZOLASYON MALZEMELERİ SAN VE TİC.A.Ş.
Ortaköy Merkez Mah. Dumlupınar Cad. No:44
Silivri / İSTANBUL - Tic. Sic. No: 501842 - 449424
Tel: (0212) 744 82 60 / Faks: (0212) 744 82 92
Silivri V.D. 1510448654

